

Open evening map 2022

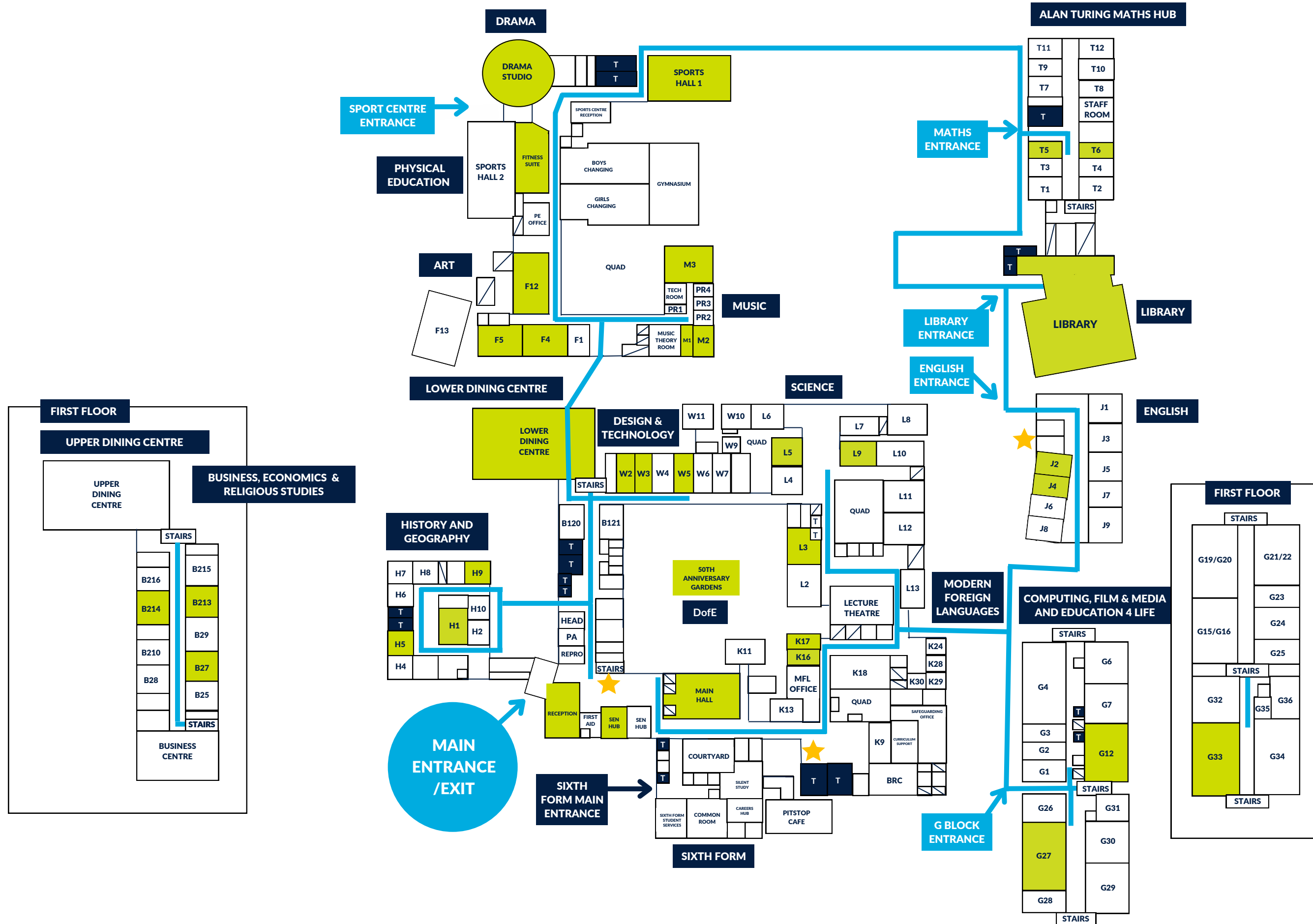

- Headteacher talks**
- Main Hall
- Curriculum**
- Art and Design: F4 / F5 / F12
 - Business Studies: B214 / B213 / B27
 - Design and Technology: W2 / W3 / W5
 - Drama: Drama Studio
 - Economics: B2.14
 - Education for Life: G12
 - English: J2 / J4
 - Film & Media: G27
 - Geography: H1
 - History: H9
 - IT and Computing: G33
 - Maths: T5 / T6
 - Modern Foreign Languages: K16/17
 - Music: M1 / M2 / M3
 - Physical Education: Sports Hall 1 / Fitness Suite
 - Religious Studies: B2.7
 - SEN: Support Hub
 - Science: L3 / L5 / L9
 - Social Sciences: H5
- Non-curriculum**
- Admissions: Reception
 - Careers: Library
 - Catering Tasters: Dining Centre
 - Duke of Edinburgh: Anniversary Garden
 - Library team: Library
 - Music performances: 'Marked by stars'
 - Young Enterprise: Reception
 - EAL: Library
- ★ 'Busking' music students